



Radio Installation Instructions 300 Series John Deere Skid Steer Loaders kit

This Kit Covers John Deere Model Numbers

317

320

325

328

332

Radio Engineering Industries, Inc.
6534 L Street
Omaha, Nebraska 68117
(402) 339-2200

JOHN DEERE 300 SERIES RADIO INSTALLATION

Introduction

Thank you for purchasing the John Deere 300 Series Skid Steer Radio Kit by Radio Engineering Industries, Inc. This manual is intended to provide the user with a summary of the information required for proper installation. If you have any questions or need assistance, please call Agri Radio Supply
1-866-424-0575

Kit System Components P/N 760869

- Main Harness (p/n 511924)
- Radio w/ ABS Housing (p/n 760869)
- Antenna 84" (p/n 210056)
- (2) Speakers (p/n 220035)
- (2) Speaker Mounting Brackets (p/n 561029)
- Hardware pack (p/n 060159)

Table of Contents

Mounting the Radio	3
Mounting the Speakers	4
Mounting the Antenna	5
Routing the Harness	6

Radio Kit Mounting Instructions

Mounting The Radio

- 1) Disconnect negative Battery terminal to prevent an accidental short circuit.
- 2) Place mount kit at driver's left hand side & inspect to assure proper fit and outside clearance. Check arm rest position, seat position, and steering arm, etc.



- 3) Mark kit's screw hole mounting locations on metal side wall for reposition later.
- 4) Remove seat from Skid-Steer for ease of installation
- 5) Drill small pilot holes at desired kit mounting location.
- 6) Secure kit to side panel with (8) supplied Philips screws.

JOHN DEERE 300 SERIES RADIO INSTALLATION

Mounting The Speakers

- 7) Loosen (4) Screws to open speaker enclosure and disconnect (+) (-) Speakers leads from speaker.
- 8) From outside lower corner of window, place speaker mount with the studs through metal cage. Place plastic speaker enclosure from the inside onto mounting studs. The studs should fit through the plastic vent holes in the speaker enclosure. Adjust speakers to desired angle and verify that the Speaker wires exit the bottom.
- 9) With other end of speaker mount bracket. Sandwich enclosure between bracket mounts and secure studs with (4) lock nuts from speaker mounting kits.
- 10) With enclosure secured to window, attach (+) (-) speakers terminal and re-attach speaker to enclosure with (4) screws. Repeat both sides.



JOHN DEERE 300 SERIES RADIO INSTALLATION

Mounting The Antenna

11) Remove the Drivers Left hand exterior head light from mounting frame.



12) Drill hole from top of cab to mount whip antenna. (Check for obstructions and verify mounting location before drilling)

13) Antenna will need to be properly grounded to receive AM Broadcasts so scuffing the paint inside around the metal teeth will be required. If not, a pigtail with a ring terminal should be used with one end mounted to the antenna and the other to the bolt as shown below.

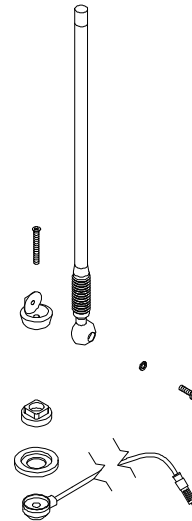
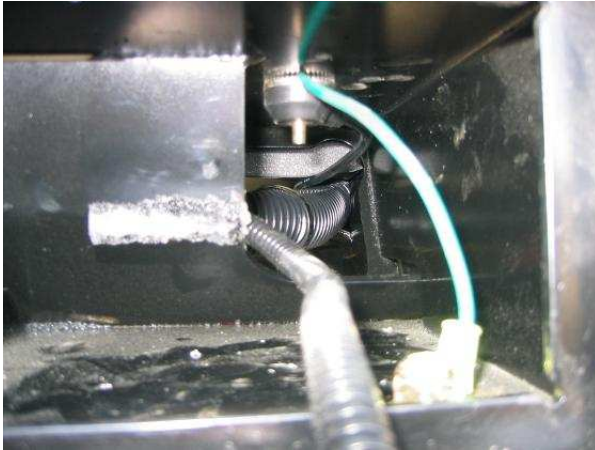

14) Route antenna cable inside cab & replace head lamp when complete.

JOHN DEERE 300 SERIES RADIO INSTALLATION

Routing the Harness

- 15) Remove control panel from top of cab and locate extra 4-pin plug. Use 12V meter & re-connect negative battery terminal. (BATT, ACC, GND, Not Used)



- 16) Connect Radio harness to plug and secure with zip ties provided.
- 17) Route antenna cable into cab and radio harness along roof line and secure with zip ties to existing flex loom.
- 18) Remove screw holding plastic A/C Duct (if equip.) and route antenna/radio harness under duct. Replace screw after securing wires with ties provided.



JOHN DEERE 300 SERIES RADIO INSTALLATION

- 19) Connect Main harness to speaker plugs (2), Radio plug, & antenna to radio.
- 20) Route Main harness & antenna along pre-existing loom and secure to loom with zip ties provided.
- 21) Re-attach negative battery lead and re assemble control panel to roof.

